

## ENVIRCO SOLUTIONS

Office : H. No. - 4, Sarita Vihar, New Delhi-110076  
 Factory : NK 166, main Road Nawada Village,  
 Sector 49, Faridabad, Haryana -121001  
 E-mail : [envircosolutions@gmail.com](mailto:envircosolutions@gmail.com)  
 Web : [www.envircosolutions.in](http://www.envircosolutions.in)

**Dinesh Kumar**  
 Head Business Development  
 Mob : +91-9313772177 | email : [dinesh@envircosolutions.in](mailto:dinesh@envircosolutions.in)  
**Nitin Sharma**  
 Head Sales & Technical  
 Mob.: +91-9625430421 | email : [sales@envircosolutions.in](mailto:sales@envircosolutions.in)



ISO 9001 : 2015



OF EXCELLENCE  
 in Architectural Acoustic World



Since 2012 As a leading supplier of Acoustic noise control Products & Services, Offers Acoustic Solutions for all kind of noise sources. With over 500+ acoustical Projects

### Products Range

- Wooden Acoustic Panels
- Fabric Acoustic Panels
- Baffle & Clouds
- Acoustic Echo Board
- Acoustic Sliding Folding Partition
- Wooden Acoustic Cum Fire Doors
- Auditorium Chair and Carpets
- Complete Architecture Acoustic Work



**ENVIRCO SOLUTIONS**  
 Innovation Redefined

E-mail : [dinesh@envirco.in](mailto:dinesh@envirco.in) | Web : [www.envirco.in](http://www.envirco.in) | Mob.: +91-9313772177



### ARCHITECTURAL ACOUSTIC SERVICES

We are Consultants in Acoustics, Electro Acoustics, Audio Visual, and Noise Control. We are one of nation's independent Acoustical consulting firms.

We provide acoustical consultancy services to Architects, Engineers, Building Owners and Industrialists. We strive to redefine the business of Acoustics, Electro Acoustics, Audio-Visual, and Noise Control.

We have highly skilled innovative team of well experienced and creative professionals, who have worked for various projects of Cinemas and Multiplex, Theatres & multipurpose halls, Hotels & Commercial Building, Civic Centre & Performing Arts Complex, Studios & Recording facilities, Classrooms, Conference rooms & Seminar Halls, Corporate Offices, Laboratories, Residential projects Home theatre, Stadiums, Worship Centre's, Metro Rail, Noise Control projects, Power Plant, Shop Floor, Test Cells, etc.

### ENVIRCO SERVICES OFFERS

We provide state of the art acoustical consultancy services within cost effective budgets to our clients. Whether your project is a new build or refurbishment, we can provide clear and complete acoustic design advices.

Acoustics – Architectural Acoustics, Sound Isolation, Acoustical Privacy, Echo Control

**NOISE CONTROL** – Building Noise Control (inside and outside noise), Industrial Noise Control as per CPCB & ISO 14001 norms, Construction Site Noise Control, Mining Noise Control, Railway / Road Noise Control, Aircraft Noise Control, Transformer Noise Control, Noise Mapping / Survey: Day and Night, Noise mitigation.

**AUDIO VISUAL, ELECTRO ACOUSTICS** – Audio Visual Facilities, Sound Reinforcement System, Digital & Film Projection, Stage Facilities, Video Systems, Background Music System, PA System, Conference System, Digital Signage System.

## About Us

ENVIRCO provides architectural Acoustics Treatments Services and Industrial Noise Pollution Control solutions as well as commercial places.

ENVIRCO is designing and manufacturing Company that has been leading the way in Noise control, Acoustics, Insulation and Green Building Products since 19 years. We design, manufacture and conduct test performance of our noise control / acoustic products for a wide variety of applications and delivering the solutions according to the site's requirement.

We manufacture next-generation products and provide customised solutions i.e. home theatre, AV integrations, noise barrier, auditoriums acoustic, Gymnasium hall, Studio and related services to industries, infrastructure and architecture organizations from an extensive range of products to choose from, which suits their aesthetic as well as acoustic requirements.

We help customers to improve their work efficiency by controlling noise at work place by providing acoustical solutions. We provide solutions based on open standards, our customers can decide what works best for them. Our objective is to give people the best product with best design and services.

### INNOVATION

It's what started our company and keeps us going today. Our noise control / acoustic products innovations have set industry standards for efficiency as per international standards and Pollution boards Norms.

### PROBLEM SOLVING

Today's Plant Noise / office acoustics challenges grow more complex and sophisticated by the day. That's why we have skilled engineers with a thorough background in acoustics and most importantly, a willingness to look at problems from a variety of perspectives.

### MANUFACTURING EXPERTISE

We specialize in solving clients problems by providing best products customized designed as per site requirement and converting our ideas into products for our customers. We utilize sophisticated and innovative manufacturing processes to ensure our operations are as efficient and reliable as possible.

### RESEARCH & TESTING

ENVIRCO products have a reputation for reliability as we are dedicated to researching and testing every product from certified laboratories for STC and NRC ratings to suggest best product as per site needs.

### VISION STATEMENT

ENVIRCO pursues market leadership by being a customer-focused, professional company delivering high quality products by innovation and value. We will grow our core business of noise control / Acoustics with superior technical solutions in systems, products and services – coupled with a cost competitive structure.



## Envirco Products Range



### ENVIRCO ACOUSTIC ECHO BOARD

ENVIRCO ACOUSTIC Echo Board 9mm/10mm/12mm thick acoustic panel for Ceiling & Wall

**Composition** :100% PET (60% Recycled) with adhesive backing

**Category** : Acoustic Panels

**Dimensions** : 1220x2440mm (+/-2mm)

**Thickness** : 9mm/10mm/12mm (+/-7%)

**Sound Absorption** : .045 to 0.65 NRC (No Air Gap)

It has high sound absorption and noise reduction characteristics. Formaldehyde emission: It is a green material with asbestos-free, non-toxic and tasteless gas under extreme temperature, protecting the ozone layer, non-irritant and recyclable. Good insulation properties, to prevent transmitting the heat from outdoor to indoor directly as partition or and ceiling, saving 35% of energy, extending the life of air conditioning. Light weight and free cutting, a variety of colours with simple corner treatment, different shape and

any pattern styles can easily reflected. Soft, natural texture, will not broke under the huge impact of high elasticity Simple maintenance, easy dust removal by vacuum cleaner or feather duster, spot can be cleaned by wet towel or cleaner.





## ENVIRCO GROOVED WOODEN ACOUSTIC PANEL

ENVIRCO Grooved Wooden Slats Sound Absorption Panels, HDF/MDF based Sound Absorption Panels on walls or ceiling over existing substrate. The panels are made of High Density Fibreboard of density about 800 kg/m<sup>3</sup> with low formaldehyde content. The top surface is laminated using 1.5mm thick laminate as approved by Engineer-in-charge. Each panel is having tongue and groove structure on the long side with an additional



groove to hold the clip of size 2400-2440mm X 128-192mm X 15mm. The back of each panels is pasted with acoustic fleece of density 80kg/m<sup>3</sup>

The front of the panel is grooved in width of 2mm/3mm and depth of 4mm while the back is perforated with holes of dia 10mm at a distance of approximately 14mm centre to centre. The installation is to be done on aluminium's channel with galvanized steel clip system. The channel is of dimension L-2400-2440 X W-25mm X Depth-20mm with the clips for each panel of size 43mm X 40mm.



22/2

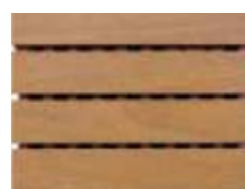

28/3



14/3



14/4

### MEASURED DATA:

| Freq (Hz) | 100  | 125  | 160  | 200  | 250  | 315  | 400  | 500  | 630  | 800  | 1K   | 1.25K | 1.6K | 2K   | 2.5K | 3.15K | 4K   | 5K   | 6.3K | 8K   |
|-----------|------|------|------|------|------|------|------|------|------|------|------|-------|------|------|------|-------|------|------|------|------|
| T1 (Sec)  | 5.87 | 5.85 | 5.85 | 4.72 | 4.67 | 4.53 | 4.32 | 4.40 | 4.44 | 4.30 | 4.25 | 4.23  | 4.04 | 3.81 | 3.64 | 3.29  | 2.79 | 2.40 | 2.01 | 1.50 |
| T2 (Sec)  | 4.56 | 3.61 | 3.61 | 2.42 | 1.80 | 1.25 | 1.23 | 1.22 | 1.32 | 1.47 | 1.47 | 1.57  | 1.70 | 1.79 | 1.87 | 1.85  | 1.72 | 1.72 | 1.28 | 1.04 |



Each channel is fixed at a distance of 600 mm. Once installed, the edges should be covered with L profile of similar shade. The panels shall be provided with 50 mm thick acoustic insulation backing which will enhance acoustic properties of entire system,

**Material Options:** Pre Laminated HDF / Mica Laminated MDF / WPC Board

**Thickness Options:** 15mm & 16 mm thick for Wall Tiles & 12 mm thick for ceiling Acoustic Panels

**Groove & Pitch Size:** 2mm, 3mm, 4mm or any groove & pitch size can be 14mm to 32mm as per any standard

**Hole Diameter:** 6mm / 08 mm / 10 mm hole dia.

**Applications:** For Wall and Ceiling Acoustic treatment in Auditorium, Home Theatre's, Conference Room, Banquet Hall, Library, Worship Places etc.

**NRC Value:** 0.75 Up to 0.95

**Installation:** On GI Channel Grid for wall & On Silhouette Grid / Aluminium T Grid for Ceiling

**Sizes:** 128mm x 2440mm, 192mm x 2440mm, 1220mm x 2440mm or any size can customize for wall & 600 x 600 OR 600 x 1200 OR 600 x 2440mm for Ceiling

**Formaldehyde Emission:** Can meet both India & EU Standard Class E1

**Flame Retardant:** Can meet India Standard Class B, BS476 Part 7 Class 1 etc.

## ENVIRCO PERFORATED ACOUSTIC CEILING/ WALL PANELS

**Material Options:** Pre Laminated HDF / Mica Laminated HDF / PVC Board

**Thickness Options:** 6mm & 12 mm thick for Ceiling Tiles & 16 mm thick for wall Acoustic Panels

**Hole Diameter:** 6mm / 08 mm / 10 mm hole dia. OR Ultra Micro Perforated hole dia 0.5 mm

**Applications:** For Wall and Ceiling Acoustic treatment in Auditorium, Theatre's, Conference Room, Banquet Hall, Library, Worship Places etc.

**NRC Value:** 0.75 Up to 0.95

**Installation:** On GI Channel Grid for wall & On Silhouette Grid / Aluminium T Grid for Ceiling

**Sizes:** 600mm x 2440mm for wall & 600 x 600 OR 600 x 1200 OR 600 x 2440mm for Ceiling

### PROPERTIES

|    |  |
|----|--|
| 1  | Class A Fire Resistance ASTM E 84 : 12           |
| 2  | Smoke Development Index ASTM E-84 : 24           |
| 3  | NRC UP to 0.95 , IS:8225 / ISO :354 / ASTM -423C |
| 4  | Termite Resistance                               |
| 5  | Fungi Resistance                                 |
| 6  | Humidity Resistant                               |
| 7  | Durable  |
| 8  | Thermal Insulation                               |
| 9  | Sag Resistant , Dowel Connection                 |
| 10 | Easy Installation                                |
| 11 | Quality Raw Material                             |
| 12 | 21 Shades available                              |

### GREEN ECO FRIENDLY PRODUCTS

#### Evaluation of Absorption Coefficient

| Freq (Hz) | 100  | 125  | 160  | 200  | 250  | 315  | 400  | 500  | 630  | 800  | 1K   | 1.25K | 1.6K | 2K   | 2.5K | 3.15K | 4K   | 5K   | 6.3K | 8K   |
|-----------|------|------|------|------|------|------|------|------|------|------|------|-------|------|------|------|-------|------|------|------|------|
| ABS Coef  | 0.12 | 0.25 | 0.33 | 0.48 | 0.82 | 1.38 | 1.39 | 1.42 | 1.27 | 1.20 | 1.06 | 0.96  | 0.81 | 0.71 | 0.62 | 0.57  | 0.53 | 0.58 | 0.68 | 0.70 |

#### Method of Measurement and Evaluation:

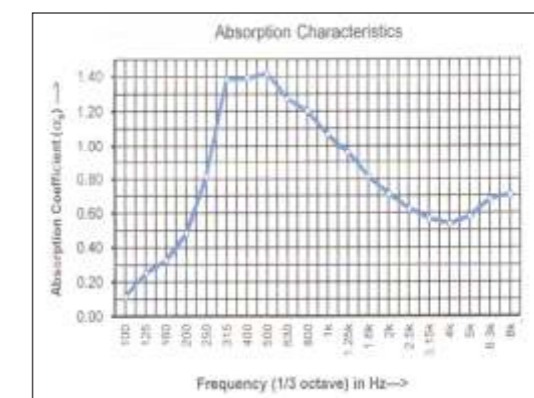
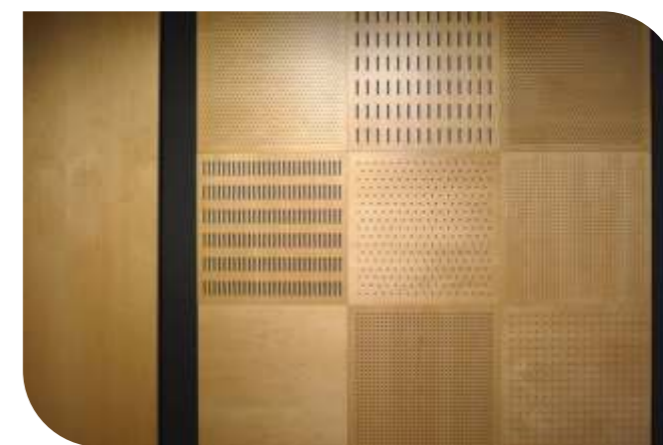

IS:8225/ ISO: 354/ ASTM 423C





## ENVIRCO HANGING BAFFLE & CLOUDS

Envirco is a leading manufacturer of acoustic hanging baffles, hanging sound baffles & ceiling sound baffles with high performance NRC ratings. Highly effective acoustic baffles to absorb noise

### Features

- Light and Moderate Weight
- High Performance with Quality Sound Absorption
- Smarter Installation with the Sound Modulation
- 100% Customer Satisfaction with Good Proven Track record
- Suitable for large noisy spaces that require a perfect noise control in order to provide you with complete satisfaction
- Economical, Multi-Purpose, High Performance, Durable, Lightweight.

**Applications** - Gymnasiums, Auditoriums, Classrooms, Music Rooms, Arenas & Stadiums, Churches, Offices, Computer Rooms, Restaurants/Cafeterias, Residential, Concert Halls & Theaters, Pro Audio, Gun Ranges, Manufacturing Plants, Machine Enclosures, Water Treatment Plants.

### Specifications:

- Brass Grommets- The material used for the purpose of preparing the baffles are the made up of brass and is quite light in weight.
- Adjustable Cable- The roof hanging that takes place through the acoustic assembling possess an adjustable

cable. It offers you with complete amount of flexibility as well as make sure that you are able to have the hanging which is full of cable hanging kit.

- Wooden Acoustic Baffle & Clouds
- Fabric Acoustic Baffle & Clouds
- Polyester Acoustic Baffle & Clouds

**Thickness** – 25 mm, 30mm, 40mm & 50mm

**Size** – 150mm x 2400 mm , 300mm x 2400mm , 600mm x 2400mm , 1200mmx 2400mm

**Flammability** - ASTM E84, Class A. Flame Spread: 5 Smoke Developed: 35

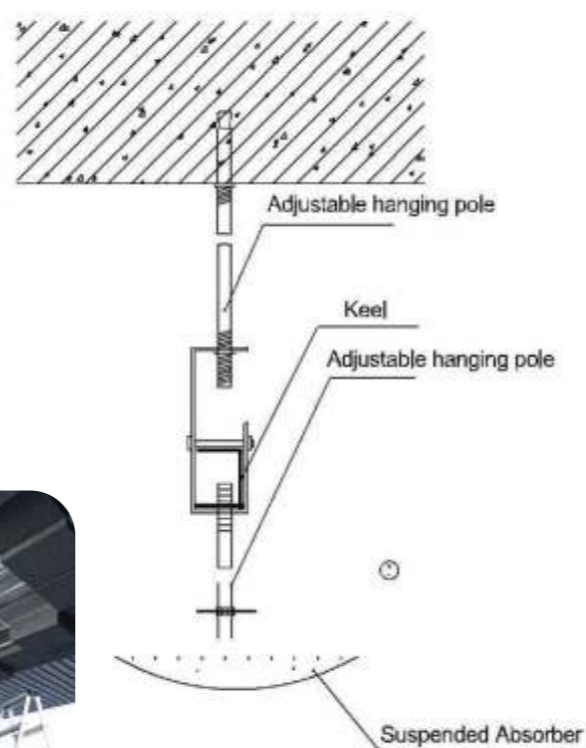

## ENVIRCO SOUND DAMPING VINYL SHEET

ENVIRCO VINYL sheets is a polymer based, bitumen-free, high-density Synthetic membrane.

The combination of its viscoelasticity and its high-density offers good sound-insulation in different construction elements without increasing thickness.

The upper face has a finish of non-woven polypropylene providing mechanical properties as well as protection. The lower face is finished with PE film.

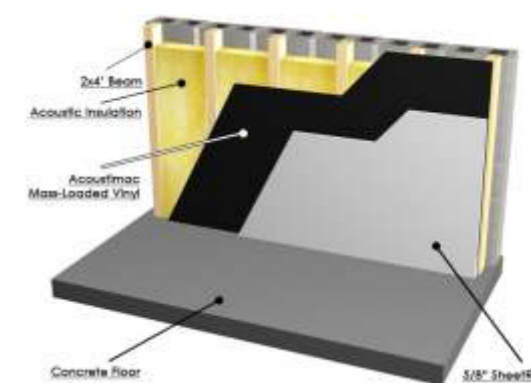

### ADVANTAGES

- High sound-insulation combined with light and rigid elements such as gypsum boards.
- High sound damping capacity on metal surfaces, thus improve insulation to rainfall noise on metal decks.
- Reaction-to fire classified.
- Flexible and adaptable to uneven surfaces.
- Good behavior at low temperatures, without breaking or cracking.
- Easy to handle and cut with a knife or scissors.
- May act as a vapor control layer.
- Negligible water absorption.
- Ageing resistance.
- Rot proof.

### APPLICATIONS

- Increases airborne noise insulation on vertical surfaces with low surface mass (plasterboard partitions, timber partitions).
- Soundproofing against airborne noise in ceilings and lightweight roofs.
- Reduction drumming noise level in laminated floors.
- Damping of noise caused by weathering such as rain and hail noise in metal deck roofs.
- Combined with sound-absorbent materials, it offers solutions with high acoustic performance.
- Its applications in the industrial field cover from the soundproofing of booths to the acoustic insulation of machine-rooms, cowling of engines, gutter pipes, sound damping of metal sheets, etc.

### Thickness Start from

- 1.75mm, Roll size 1.22x5 MTR, Weight 3.5kg/m2
- 2.5mm, Roll size 1.22x6MTR, Weight 5kg/m2
- Thickness 3.5mm, Roll size 1.22x5MTR, Weight 7kg/m2
- Thickness 5mm, Roll size 1.22x4MTR, Weight 10kg/m2

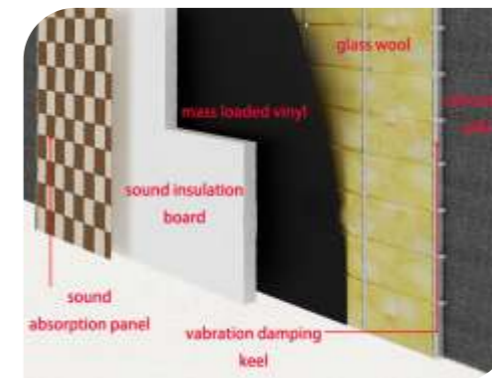

| TECHNICAL SPECIFICATIONS      |                              |
|-------------------------------|------------------------------|
| Density                       | 2000 Kg/M3                   |
| Tensile strength              | >30 N/50mm                   |
| Elongation (NT-67)            | >500 %                       |
| Cold flexibility              | -20 °C                       |
| Tear Strength (nail)          | 153-235 N/50 mm              |
| Fire class (UNE-EN 13501-1)   | Bs2d0                        |
| Vapour water resistant factor | $\mu > 1806$                 |
| Water absorption (24h a 23°C) | 0,003 %                      |
| Shore hardness A              | 30 $\pm$ 10                  |
| Young module (E)              | DM - 1,35637 DT - 1,1744 Mpa |
| Poisson coefficient           | 0,23                         |
| Sound Reduction Index, Rw     | 34 dB(A)                     |

### INSTALLATION SUBSTRATE:

- The substrate must be even, smooth, clean and dry. It must also be free from elements that could damage the membrane. If the rendering is old, its condition must be checked to avoid adherence problems of the TECSOUND sheet to the rendering.

### INSTALLATION OF THE MEMBRANE ON METAL DECKS:

- Extend the roll over the substrate progressively, fleece upwards, with an overlap of at least 5 cm. In case of direct installation on top of the steel deck, the membrane must be applied perpendicular to the direction of the deck profile. In case of a mechanically fixed insulation and waterproofing systems, specifications of type and number of fasteners needed must be respected.



## ENVIRCO WRAPPED ACOUSTIC FABRIC PANEL

Decorative Fabric Wrapped Custom Acoustical Wall Panels

- High Performance
- Architecturally Decorative
- Custom Engineered & Manufactured
- Reduced Noise & Reverberation
- 100% Custom Colors and Sizes

### Product Specs

**Material:** - High density glass fibre, Wood Fibre, Perforated board OR Melamine Foam with woven fabric and micro perforated vinyl facings.

**Pattern:**- Flat-faced with square or radius corners, bevelled, radiuses or metered edges.

**Features:**- Custom designed and manufactured to meet every need. Soft or hard edges

**Applications:**- For wall and Ceiling Acoustic, These decorative sound absorbing panels are great for offices, schools, meeting rooms, music rooms, hotels, auditoriums, recording studios, broadcasting studios. These acoustic wall panels are perfect for any space where good speech privacy or speech intelligibility is important.

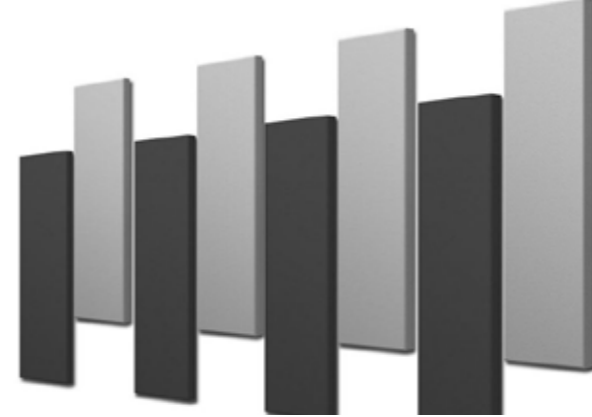

**Thickness:** - 6mm, 15mm, 25 mm & 50 mm for ceiling & wall.

**Size:**- 600 x 600mm or 600 x 1200mm or Custom Up to any size.

**Colors:**- Acoustical cloth comes in a wide range of standard colors and custom colors are available for woven fabrics and perforated vinyls.

**Flammability:**- ASTM E84, Class A. Flame Spread: 15; Smoke Developed: 40.

**Installation:**- Grid Channel, Hook & Loop Fasteners, Mechanical Clips, Impaling Clips, magnetic clips, Adhesive.

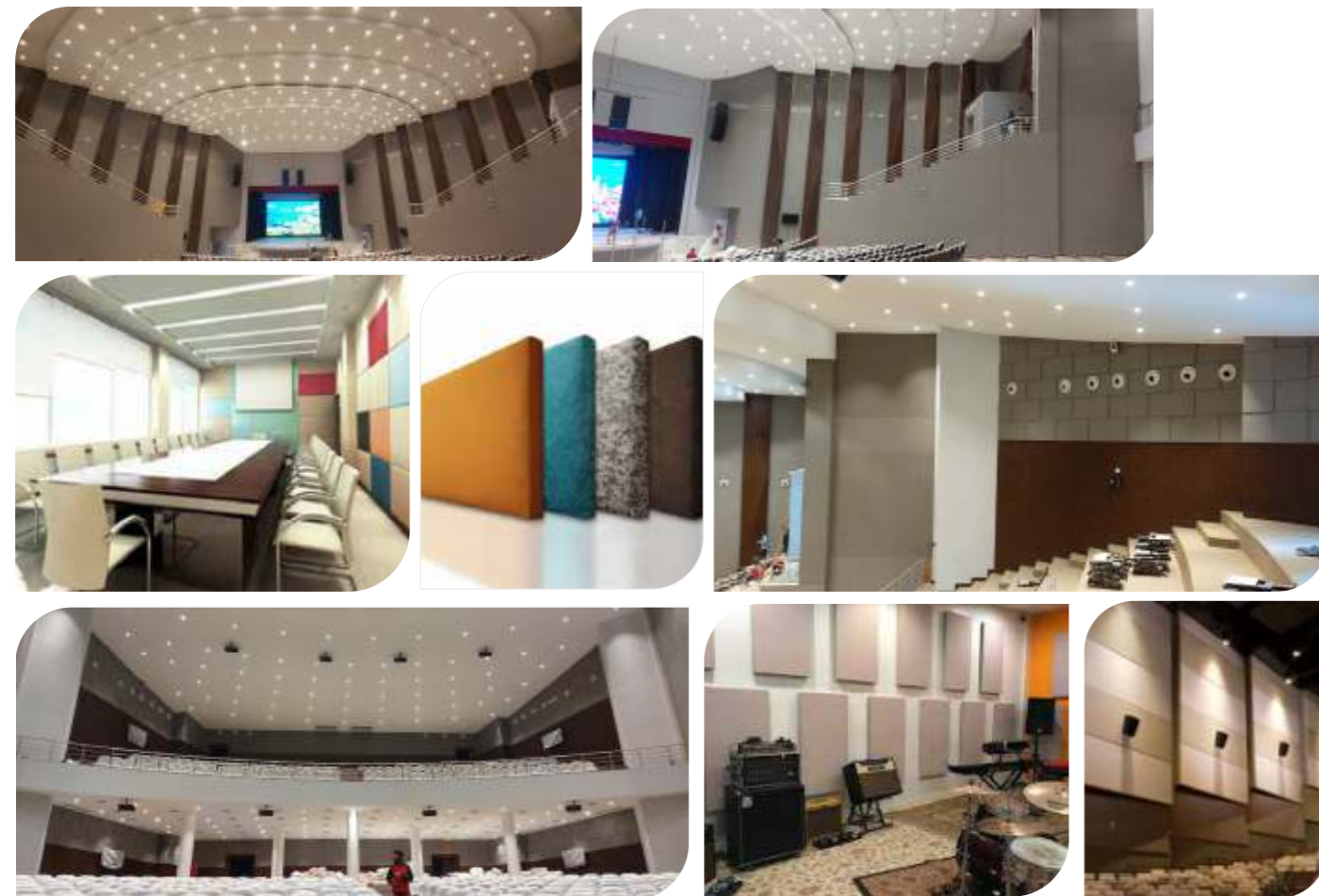

## ENVIRCO STRETCH FABRIC ACOUSTIC SYSTEM

ENVIRCO Stretch Acoustic System give high acoustic performance high quality and removable fabric finish for walls and ceilings Add beauty and ace for an effective sound control by connecting fabric panels with the finishes in the other surface as well Insulation material 50 MM ROCKWOOL with GI stud and covered with two layer of tissue paper& 12 & 25 MM Gripper networking with tucked stretchable fabric. Which is a stretch fabric system widely demanded for its high caliber with the warmth.

### Features

- Effortless to integrate outlets, switches and lighting
- Takes virtually any kind of fabric
- Finished edge is tight to wall
- Any depth can be accomplished or multiple panel depths can be applied
- Fabric is stretched, not glued; allows for high tension applications
- No sagging, gaps, or misfitting of fabric
- Perfect tolerance close to all architectural situations
- All work finished on site
- Multiple core materials can also be utilized
- Fabric can be separated for replacement

### Easy to fit Architectural Design

The size of stretch fabric wall panel can be design as per space available at site, it becomes effortless to form shapes and designs, which are generally not formed by the traditional systems. The stretch fabric system can be placed with acoustic insulation backing which is in visible and give good NRC performance.

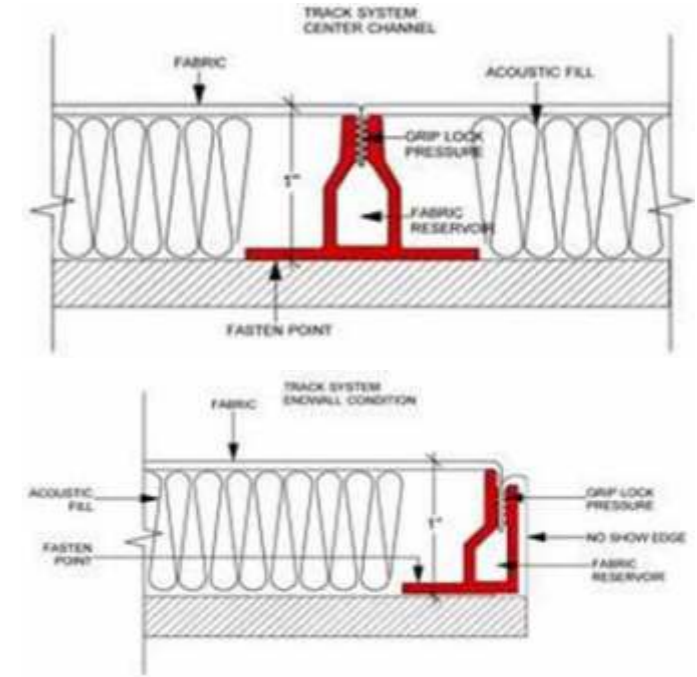

### Environment and Sustainability

Environmentally friendly core materials such as recycled glass / polyester; fiberglass can be use as acoustic insulation backing material also fabric can be fire retardant and available in different color choice which will flow positive energy.

### Reduced Maintenance

The fabric can be removed and replaced which is inserted with the plastic track system. The damaged areas of fabric and of color scheme is simple to maintain.

### Installation Details:

The fabric is acoustically transparent and transfers IS 11871, Method A Class fire certificate.





## ENVIRCO MULTIPURPOSE WOODWOOL INSULATION BOARDS

ENVIRCO SOLUTION Is India's pioneer manufacturer and supplier of Woodwool Insulation Boards with the brand name ENVIRCO. ENVIRCO' the light weight Multipurpose – Thermal, Acoustic & Structural Woodwool Insulation Boards are manufactured in a safe and non-toxic process using one of the most common Natural Resource available to the mankind since Evolution i.e. 'Wood'. Long Pine Wood Fibers i.e. Woodwool [excelsior] is mineralized with Magnesite and an inorganic Salt, laid into dyes and Hydraulically compressed into Panels.

ENVIRCO panels are Eco friendly and contains no toxic binders, resins, no asbestos or formaldehyde and are naturally degradable in a landfill. ENVIRCO Panels are of regular porous structure, not brittle and doesn't get affected by Fungus, Termites or Insects. Inspire of being made of wood wool ENVIRCO panels are highly Fire Resistant.

Measurement of Sound Absorption Coefficient in Reverberation Room As per IS:8225-1987 Equivalent to ISO:354-1985 and ASTM 423-90A

| Fibrecrete Natural | Description                               | 125  | 250  | 500  | 1000 | 2000 | 4000 | NRC  |
|--------------------|---|------|------|------|------|------|------|------|
| 15mm<br>400 kg/cuM | 50mm Polyfiber 1000 GSM<br>+300mm Air Gap | 0.64 | 0.98 | 0.70 | 0.88 | 0.90 | 0.93 | 0.87 |
| 20mm<br>400 kg/cuM | +50mm Glass<br>Wool 24 kg/cuM             | 0.33 | 0.61 | 0.87 | 0.96 | 0.78 | 0.80 | 0.80 |
| 20mm<br>400 kg/cuM | +50mm Glass<br>Wool 32 kg/cuM             | 0.26 | 0.75 | 0.92 | 1.00 | 0.59 | 0.80 | 0.80 |
| 25mm<br>400 kg/cuM | +50mm Glass<br>Wool 24 kg/cuM             | 0.22 | 0.70 | 0.98 | 0.78 | 0.71 | 0.80 | 0.80 |

ENVIRCO Woodwool Panels are ideally used for Thermal as well as Acoustic Insulation in False Ceiling, Wall Paneling, Roofing, Partitions, Permanent Shuttering and Under flooring. Its porous inner structure effectuates an effective sound absorption. 'ENVIRCO' ARE THE BEST SUITED FOR REGULATION OF REVERBERATION.

**Size:** 600mm x 600mm , 600mm x 1200mm, 1220 x 610mm Natural Standard with 400 \$ 450 kg/cuM Density

**Thickness:** 15mm, 20mm, 25mm, 40mm

ANY COLOR Options Possible from shade card

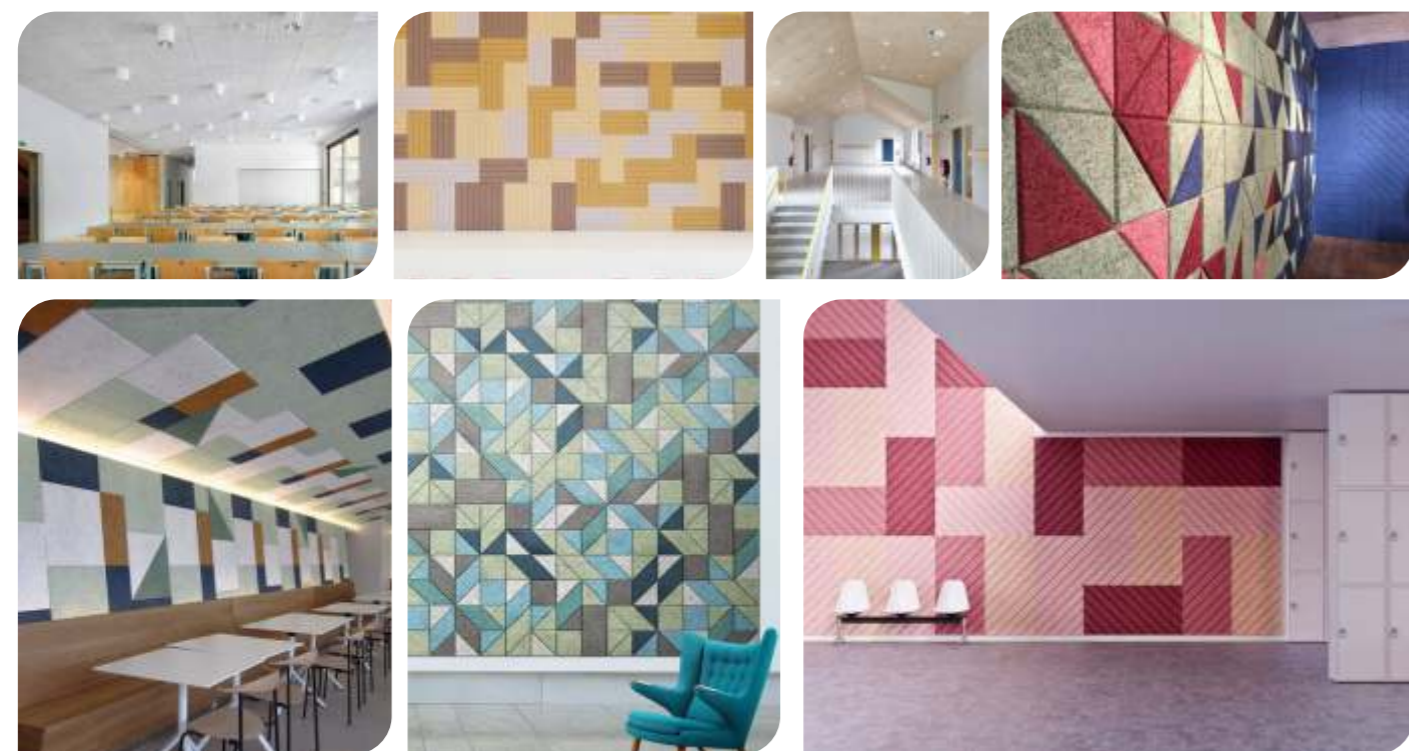
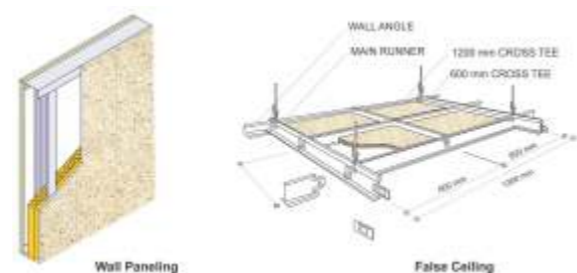

## ENVIRCO ACOUSTIC PU FOAM

We manufacture acoustic PU foams to provide sound attenuation. The open celled foam is very effective in absorbing sound and reducing reverberation in commercial locations. PU foam is the most effective material for absorption of airborne sound

### Acoustic Wedge Foam

The acoustic wedge foam is designed as long rows of wedges on the sheet. The acoustic wedge foam sheet comes in different sizes and can be further cut if required. It is highly effective for soundproofing mid to high range sound frequencies. The thickness of the foam can be selected based on the noise level control required.

### Acoustic Pyramid Foam

The acoustic pyramid foam is better at diffusing sound. The interlacing of air spaces with the foam and the 4 side opening provides better noise attenuation. Pyramid foam is suitable for creating sound proof rooms like recording studios. It has among the highest noise reduction coefficient for a surface.



### Properties

- Product : P.U. Foam
- Foam Type : 32 FR
- Colour : Grey

PU foam wedge Absorbers are manufactured from PU Foam Grey colour , 32kg /m3 density Fire retardant polyurethane foam .Tested from ARAI for Random Incidence Sound Absorption Coefficient (RISAC) as per IS-8225/ ISO – 354 standards & also tested for flammability test as per UL 94-1998; clause 12 , HF-1Class



| S. No. | Parameter   | Specified Value | Test Method | Observed Values |
|--------|---|-----------------|-------------|-----------------|
| 1      | Density (kg/m3)                                   | 30 + 1          | IS-7888     | 31              |
| 2      | Tensile Strength (kg/cm2)                         | >= .80          | IS-7888     | 1.07            |
| 3      | Elongation (%)                                    | >= 120          | IS-7888     | 130             |
| 4      | Hardness value (IFD) Kg/323 Cm2 @ 50% Compression | 30 To 40        | IS-7888     | 37.03           |
| 5      | % Resilience                                      | >=30            | IS-7888     | 34              |
| 6      | F.R. Properties                                   |                 |             | Comply to UL 94 |



## ACOUSTIC WOODEN DOOR

**WOODEN ACOUSTIC DOOR:** 55mm to 76mm thick sandwich type Face panels shall be of 12 mm thick Marine ply boards based on International Standards on both sides of the core of the shutter with required primer at the unexposed surface. One side of ply board shall be fixed to the core of the shutter along with a 5 mm thick Neoprene rubber sheet on its inner face.

01 mm mica OR 04 mm thick Teak Veneer of approved make shall be bonded with 12 mm thick marine plyboard on both face of shutter by using high strength cross linked PVAC based adhesive as well filled with acoustic insulation material, sound absorbing and damping material

Door frame shall be of teak / hard wood of size – 110 mm X 100 mm, fixing of hollow bulb type EDPM gaskets on rebates to block noise leakage from gap in between door frame and shutter.

Frame of shutter shall be made from 40 mm thick teak / hard wood stiles and top & bottom rails of size 94 mm and core made of lock rail 100 mm wide and 40 mm thick and three additional strips 50 mm wide and 25 mm thick (minimum)

**Dropdown Seal:** Excellent quality range of Internal Automatic Dropdown Seal, which are manufactured from high grade quality raw materials, can be customized as per our precious customer's specifications. Resists sound upto 37db, air, insects, cold smoke, light.

**Hardware:** Door Lock, SS Bal bearing Hinges , SS door handle 'D' type back to back, SS Tower bolt

## WOODEN ACOUSTIC FIRE DOOR

ENVIRCO provides you multifunctional product Construction of the Wooden Fire Door with SOUND RETARDANT is the same as that of a Standard Wooden Fire Door with an Addition of the Automatic Drop Seal for the Bottom horizontal plane and Silicon Self Adhesive Seals on the sides of the panel.

**Door Frame:** Wooden Door Frame of hard wood/ teak wood section 150mm x 95mm with heat activated intumescent fire seal strip of size 15mm x 4mm and finished with one coat of anti-termite fire retardant primer or paint and fitted with acoustic seal on all three sides.

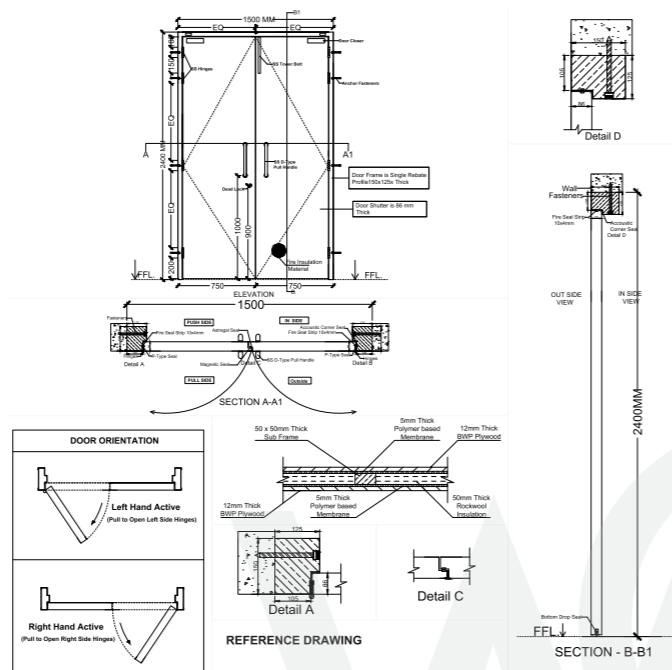

**Door Shutter:** 65mm thick acoustic cum fire/smoke check Shutter of 38 db acoustic cum of 120 minutes rating confirming to BS 476 Part-22 & IS: 3614 part-2 comprising of sandwiching 29mm thick fire resistance insulation material between two 12mm thick calcium silicate board faced with 6mm thick commercial/teakply with heat activated intumescent fire seal strip of size 15mm x 4mm mounted on all three sides except bottom along with acoustic seal..



## ENVIRCO ACOUSTIC SLIDING FOLDING PARTITION

### PRODUCT SPECIFICATION

**PANELS:** 85mm thick Panels will be made from 12mm MDF / Clipboard Panels hung in Acoustic Isolation from the frame and allowed to vibrate independently of the frame. The Panels must be filled with Acoustic material Rockwool of 64Kg/m<sup>3</sup> density & MTS Sound Damping layer of 3mm thick high density material to achieve Sound STC of 51dbA as per site condition. The width of panel will be from 800 mm to 1200 mm maximum, as per site condition. The panel faces shall be finished with selected material.

### TRACK & TROLLEY:

Each Panel shall be suspended on Extruded 6063 - T5 Anodized Aluminum Track, Steel Cold Ball Bearing Rollers / Trolley of material nylon wheel made with the base Material of POM 45 tempered steel, maintenance free with multiple Balbearing.

### ACOUSTIC INSULATION:

The Panels filled with Acoustic material Glass wool of 48 Kg/ m<sup>3</sup> density , 6 MM thick anti donning layer having Thermal Conductivity 0.037 @ 20 C as per EN ISO 8497 (DIN 52613) and 2 mm thick Sound Damping layer MTS 05-303 to achieve higher Sound STC as per site condition.

### STC RATING OF PARTITION PANELS:

Is 51 at 4000Hz as per National Physical Laboratory, New Delhi'.

### PANEL SURFACE FINISH:

MDF, MICA, FABRIC & ECHO Panels.

### OPERATION:

Partitions shall be top supported, manually operated no floor track shall be used.

### STACKING:

Central Stacking, One Side Stacking OR two Side Stacking or as per architectural plan.



STANDARD FIXING DETAILS ONLY FOR YOUR REFERENCE :

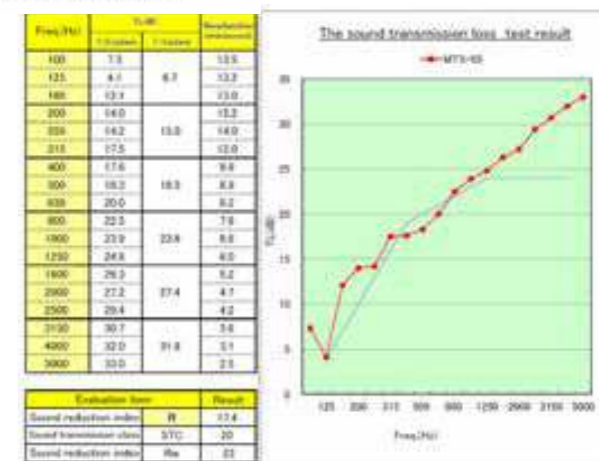
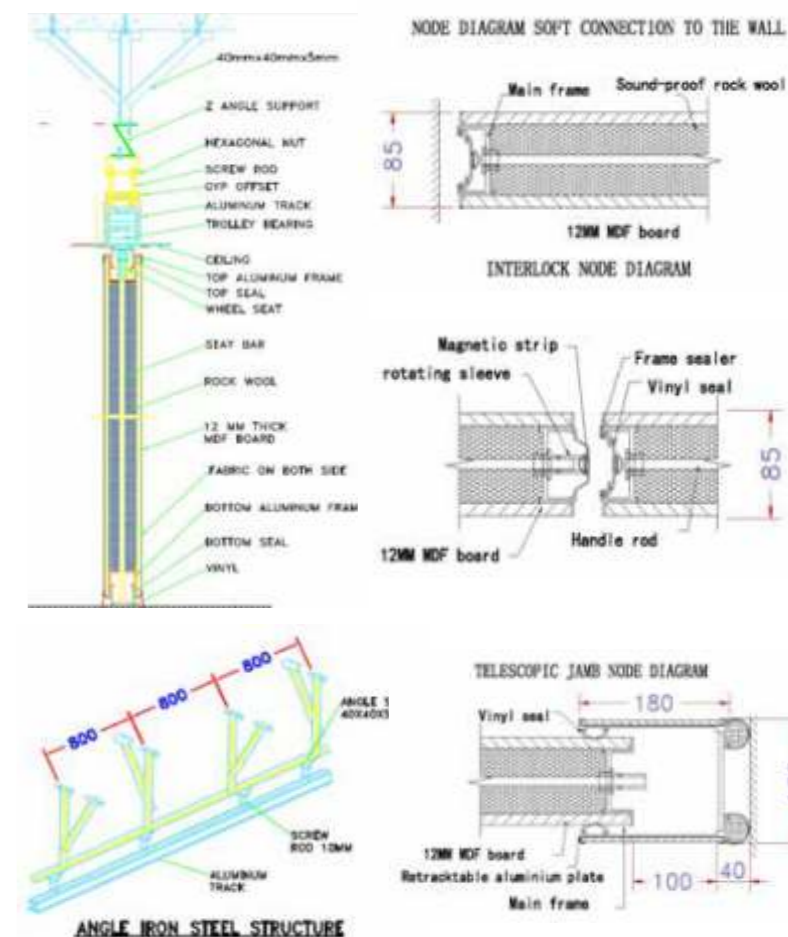



### COMPLETE ARCHITECTURAL ACOUSTIC WORK FOR AUDITORIUM & HOME THEATRES

Home theater rooms are gaining popularity in India. With the best home theater systems like 3D TVs, projectors and surround sound, you can easily bring Bollywood into your home.

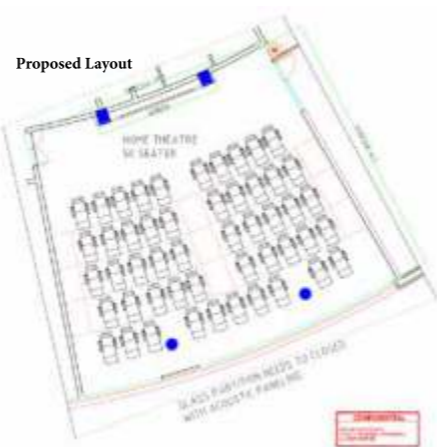
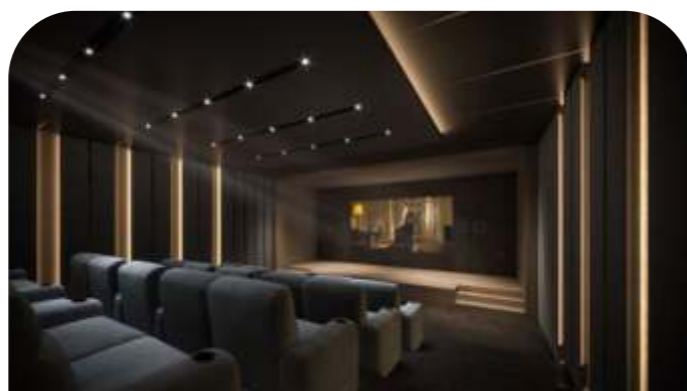
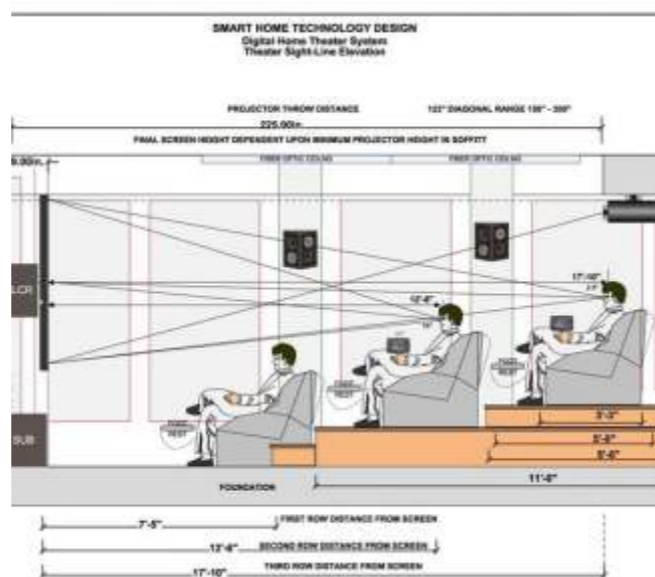

### VIRTUAL/E- CLASSROOM-LECTURE RECORDING, STORING AND LIVE STREAMING, ONLINE CLASSES



### VIDEO CONFERENCING SOLUTION



### PRODUCTS OFFERED











Audio Podium / Digital Multimedia Podium



### PRODUCTS OFFERED



### AUDIO

|  |   |   |   |  |
|--|---|---|---|--|
| <br>Cordless Lapel Microphone | <br>Boundary Layer Microphones | <br>Ceiling Microphone | <br>Chairman & Delegate Unit | <br>USB Microphone      |
| <br>Column Speakers           | <br>Wall Mount Speakers        | <br>Ceiling Speakers   | <br>Line Array Speakers      | <br>Line Array Speakers |